

# Vinyl Wall Decor Installation Instructions

## Tools required

The installation of the wall panels will require few tools. You will need a hand drill, knife, measuring tape, stud finder, level and hammer.

## Preparation

Locate studs on the surface where you will install the wall panels and make a mark on the wall to identify the position of the stud **(1)**.

Normally studs should be present 16" on center for interior walls and 12" on center for exterior walls. It is important to identify the studs as this is where you will fasten the wall décor.

## Installation

Using a level, mark a horizontal guide line at the base of the wall. This line is important as this is where you will install the first panel.

Note: We strongly recommend to fasten each full panel with four screws (included) with a minimum of 2 screws fastened to studs **(2)**.

Carefully drive the screws through the lip (on the groove side) of the panel until the head of the screw is flush to the lip. Do not overtighten and this will weaken the strength that is needed for a secure hold.

- A) Install and fasten the first panel aligned on the guide line, tongue side pointing downward.  
Second panel **(3)**: insert the tongue of the second panel into the groove of the first panel on the short side and align on the guide line, fasten **(2)** and continue this process until the end of the wall.
- B) Second Row: If the left-over portion of the last panel on the first row is less than 16" you should not use it. If this is the case, take a full panel, cut a portion (6" to 10") on the right side of this panel (you may use this portion to terminate a row) and install the remainder of the cut panel as a start-panel for the second row **(4)**.

Second panel: insert the tongue of the second panel to the groove of the first panel on the short side **(3)**, fasten **(2)** and continue this process until the end of the wall.

This staggered system will give you the look and stability you need for optimal performance. Continue the installation process until completion of your project.

- C) Finishing: Once the installation of panels is complete install a coordinating wood trim where applicable.

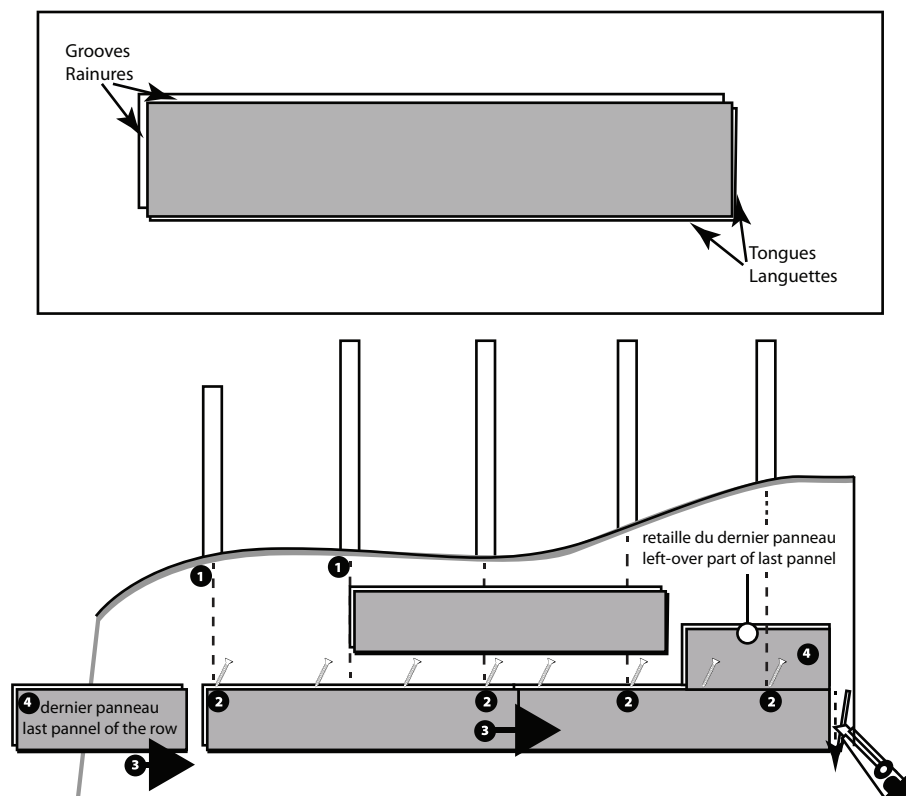

## IMPORTANT WARNING

If you plan to install Walls with Style panels close to any heat source, get the approval of a certified building professional.